



## High Current SMD Power Inductors - SEP3012ET-A SERIES



### PART NUMBERING SYSTEM

(AEC-Q200)

<b>SEP</b>	<b>3012ET</b>	—	<b>3R3M</b>	—	<b>LF</b>	—	<b>A</b>
TYPE	DIMENSIONS		INDUCTANCE		LEAD FREE		Automotive

### FEATURES :

- Magnetically High Current Power Inductors .
- Low profile ( 1.2mm max. height ) and 3.2 mm max. square compact original design .
- Low acoustic noise and low leakage flux noise by shielded construction .
- Halogen Free , 100% lead ( Pb ) Free and RoHS compliant .

### SHAPES AND DIMENSIONS :

UNIT : mm

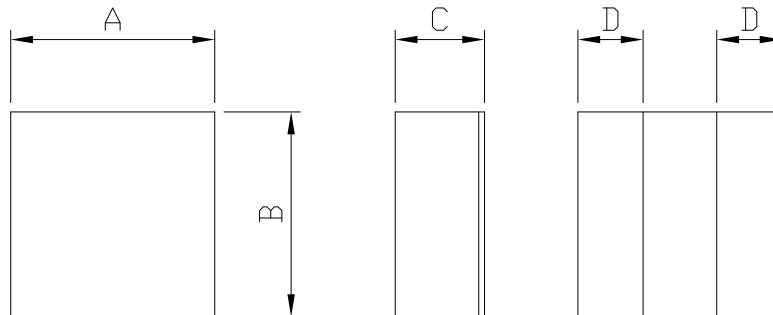

**A=3.0±0.2 B=3.0±0.2 C=1.2 Max. D=1.2 Max.**

### RECOMMENDED PATTERNS

UNIT : mm

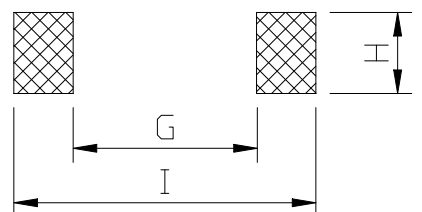

**H=3.4 G= 0.8 I = 3.4**



## High Current SMD Power Inductors - SEP3012ET-A SERIES



### SPECIFICATION TABLE

PART NUMBER	INDUCTANCE (μH)	Isat ( A ) (Max.)	Irms ( A ) (Typ.)	DCR (mΩ) (Max.)	TEST FREQ. ( Freq. )
SEP3012ET-R33N-LF-A	0.33±30%	11.1	3.40	22.8	100KHz/1V
SEP3012ET-R47N-LF-A	0.47±30%	9.40	3.20	26.4	100KHz/1V
SEP3012ET-R56N-LF-A	0.56±30%	8.50	3.00	34.8	100KHz/1V
SEP3012ET-R68N-LF-A	0.68±30%	7.70	2.70	43.2	100KHz/1V
SEP3012ET-1R0M-LF-A	1.0±20%	5.20	2.50	51.0	100KHz/1V
SEP3012ET-1R2M-LF-A	1.2±20%	5.00	2.30	66.0	100KHz/1V
SEP3012ET-1R5M-LF-A	1.5±20%	4.70	1.90	96.0	100KHz/1V
SEP3012ET-2R2M-LF-A	2.2±20%	4.60	1.70	115	100KHz/1V
SEP3012ET-3R3M-LF-A	3.3±20%	3.70	1.30	180	100KHz/1V
SEP3012ET-4R7M-LF-A	4.7±20%	3.30	1.00	308	100KHz/1V
SEP3012ET-5R6M-LF-A	5.6±20%	3.00	0.90	389	100KHz/1V
SEP3012ET-6R8M-LF-A	6.8±20%	2.40	0.80	424	100KHz/1V

- Isat : DC current at which the inductance drops 20% (typ) from its value without current.
- Irms : Average current for a 40°C temperature rise above 25°C ambient.
- Operating temperature range -40°C to +120°C , Electrical specifications at 25°C .

### PACKAGING SPECIFICATION

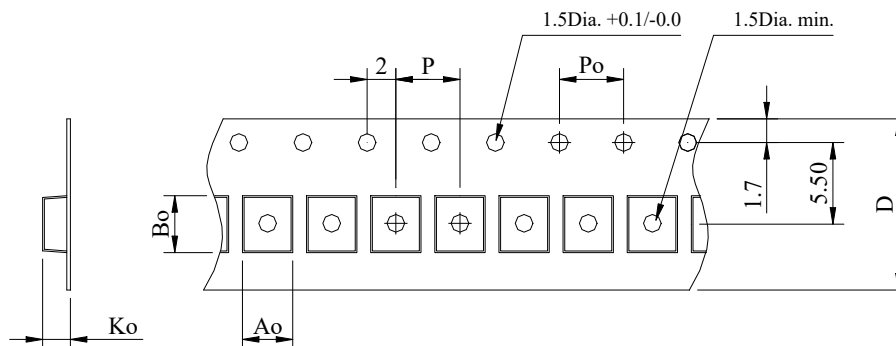

STAYLE	Q' TY (PCS)	DIMENSIONS (m/m)					
		Ao	Bo	Ko	P	Po	D
7"	1,000	3.5±0.1	3.5±0.1	1.4±0.1	8±0.1	4.0±0.1	12±0.3